

# INNOVATION AND DESIGN

CORPORATE PRESENTATION 2023



# WHO WE ARE

## VALUES

- More than 25 years of dedication to the automotive and industrial equipment production sector.
- At the end of the 1980s, Juan Antonio and José Ramón Martínez made the leap from the world of repairs to the marketing of equipment throughout Spain. Later on, they decided to start manufacturing paint spray booths, extending their activities to the international market.
- At the beginning of the 90s, the company's VISION was very clear: "any repair and painting centre that decides to buy or update tools or equipment, think of us". They created a MISSION: to have a catalogue under a single brand with which to provide any workshop with equipment or tools, creating a slogan "the turnkey repair". Afterwards, the leap is made to all of Latin America.
- In 2011: As a result of the experience and knowledge acquired in the area of surface finishing. Martech Car is created, a new brand with the most advanced technology on the market, covering the broadest sectors of the industry that require a painting process.





# GROUP COMPANIES

## SECTORS OF ACTIVITY:

- Industry
- Automotive
- Repair equipment suppliers
- Consultancy on repair processes

The restlessness of the founders of Martech Group led them to take initiatives in different market sectors, creating a group of companies that operate in different areas and sectors, both in the national and international market.

### **SPANESI INTERNATIONAL**

Market leading equipment supplier with the widest range of equipment in the automotive repair sector for the Iberian Peninsula.

### **MARTECH CAR**

Its activity is focused on the internationalisation of its extensive catalogue of equipment for the automotive sector through its network of importers and customers in international markets.

### **MARTECH INDUSTRY**

Focused exclusively on designing, projecting and executing projects in the field of surface treatment and final finishing, for the national and international market in the different sectors of industry, with strategic sectors such as: Railways, Aeronautics, Wind Energy, Wood, Metal Mechanics, etc.

### **REPAUT AND ALICAR**

Repair, testing and process control centres for the automotive sector

### **CAR DEALERS**

Official dealers of leading brands (BMW, SKODA)



# WHAT WE DO

## HUMAN TEAM:

- **Project**
- **Design**
- Execution
- Post - sale
- Remote assistance

## DRAFT:

- At Martech Group, we are committed to the implementation of highly productive processes. This involves training and providing the necessary knowledge to carry out a productive, efficient and quality flow. Advice, support and auditing are the key to success.
- Sales Department with extensive knowledge and specialisation in the different sectors in which the company operates, with the technical capacity to advise on the best cost-benefit solution for the client.

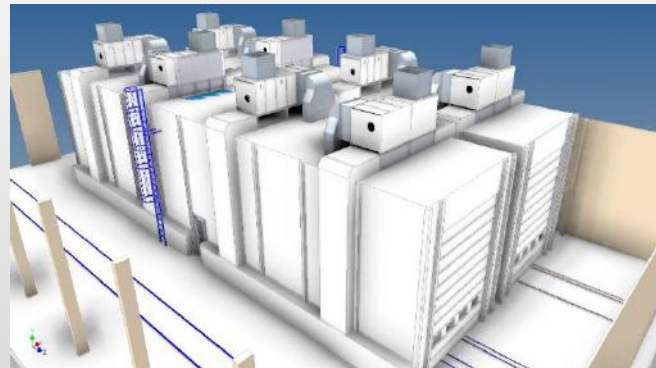

## DESIGN:

- An engineering team, highly qualified in the development of 3D projects, made up of senior engineers, designers and planners, committed to developing solutions that optimise productivity and at the same time are: efficient, cost-effective, guarantee profit and meet the real needs of our customers.
- Our Technical Project Office provides a comprehensive service and advice for new assemblies and installations. "Turnkey" with implementation of customised processes and audits.





# WHAT WE DO

## HUMAN TEAM:

- Project
- Design
- Execution
- Post - sale
- Remote assistance

## EXECUTION:

- We specialise in managing turnkey projects with the implementation of customised processes and audits, simplifying the intervention of a single interlocutor with the client.



## AFTER-SALES:

- We guarantee local technical assistance, with the presence of our own qualified technicians throughout the country. Allowing our customers the possibility of preventive maintenance contracts, with competitive costs.

## REMOTE ASSISTANCE:

- We can provide remote supervision from our headquarters, monitoring any failure in the installation and issuing automatic alerts.

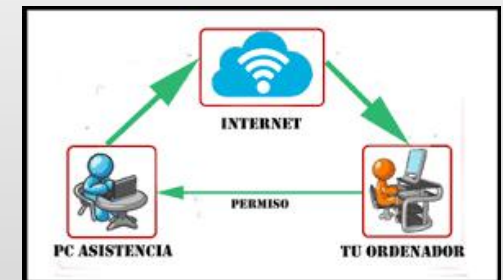



# TECHNOLOGICAL DEVELOPMENT

## TECHNOLOGICAL DEVELOPMENT

- **Endothermic panels**
- Direct Combustion
- Infrared Systems

### **Endothermic panels:**

- One of Martech Group's main concerns is the search for new technologies and production processes that allow us to reduce costs in our work processes. This concern and taking advantage of our own repair centre, we develop and test new energy efficiency systems, which has allowed us to develop systems with greater energy efficiency, such as ENDOTHERMIC PANELS.
- **Leaders in the installation of endothermic panels,**
- **More than 1000 installations are our guarantee.**
- **The system allows a reduction in the total work cycle by more than 30%.**





# TECHNOLOGICAL DEVELOPMENT

## TECHNOLOGICAL DEVELOPMENT

- Endothermic panels
- **Direct Combustion**
- **Infrared Systems**

### **Direct Combustion:**

- Developed mainly for large volume paint booths. Its main virtues lie in the wide range of regulation and modulation, taking advantage of 100% of the combustion, avoiding unnecessary losses.
- Martech Group installs its own equipment, with no dependence on third parties for commissioning, which means lower costs for the customer.

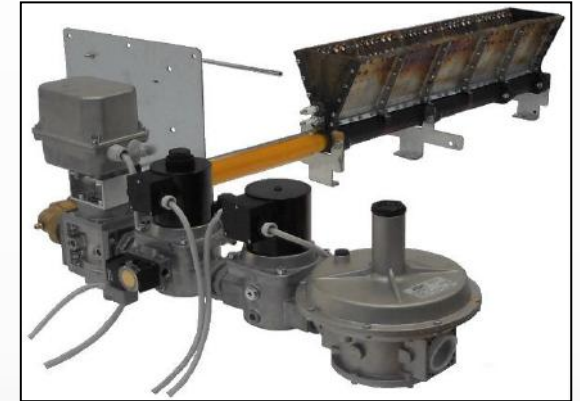

### **Infrared Systems:**

- Motorised automatic I.R. bridge with software controlling power, speed and temperature. With the advantage of manual movement to the start position.





## OUR RESULTS



6 Training Centres



+8000 Installations carried out



1 Show Room



2 Automotive Repair and Testing Repair Centres



Agreements with Road Repair Experimentation Centres:  
CESVIMAP, CENTRE ZARAGOZA





## OUR NUMBERS

**30**

YEARS OF EXPERIENCE, as market leaders in the supply of repair equipment.

**8000**

CUSTOMERS, have placed their trust in our products

**20**

COUNTRIES, with a consolidated presence.



# OUR CLIENTS

## CUSTOMER RELATIONS:

- Aviation
- Automotive
- Industry
  - ✓ Wood
  - ✓ Metalworking
  - ✓ Wind
- Railway

## Aviation



## Automotive

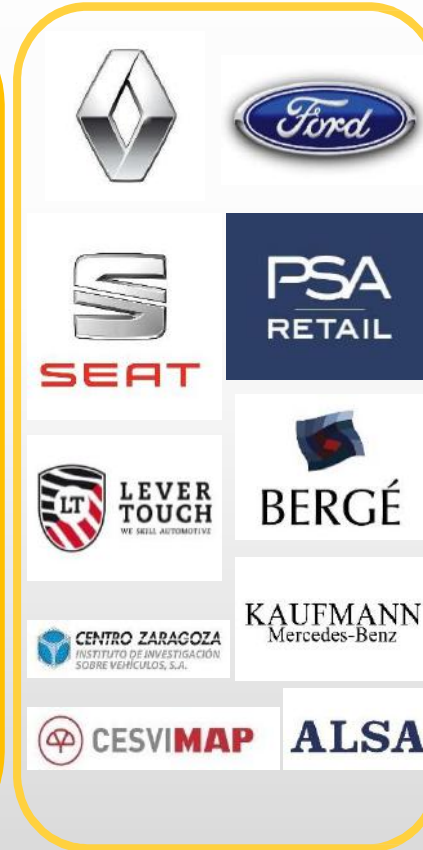

## Industry



## Railway





# MARTECH GROUP IN THE WORLD

## DELEGATIONS

- Europe
- North America
- Central America
- South America
- Caribbean

## FACILITIES:

- Angola
- Thailand
- France
- UX
- .....



### EUROPA

España, Portugal.

### AMÉRICA CENTRAL

Costa Rica, Guatemala, Panamá,  
El Salvador, Nicaragua, Honduras.

### CARIBE

Cuba, Puerto Rico.

### NORTE AMÉRICA

México.

### SUDAMÉRICA

Venezuela, Colombia, Perú, Ecuador, Bolivia,  
Uruguay, Paraguay, Chile, Argentina.



# WHY MARTECH GROUP?



Company with the best technology and modern equipment on the market, always with the commitment to include the latest innovations.



A company recognised worldwide and approved by the main manufacturers.



ISO 9001 quality certified company, to demonstrate the good management carried out in all its departments.



Company with the most extensive catalogue in the market, capable of supplying 100% of the right equipment and tools for each process and area of repair.



A company committed to the environment and the ergonomics of the equipment to facilitate and carry out comfortable and efficient work, to achieve the maximum quality that customers deserve. Our motto is "finishes as they left the factory".



Experience in developing cost-effective, space-efficient and balanced cost/benefit solutions.



# MEANS OF PRODUCTION

**FACTORY**







# MEANS OF PRODUCTION

**FACTORY**





# MEANS OF PRODUCTION

**FACTORY**







# MEANS OF PRODUCTION

## FACTORY

Automatic cutting,  
punching and  
folding line.





# FACILITIES



## RAIL

### BMI High Speed (Valladolid)

- ✓ Preparation and painting booth
- ✓ Evolutto control panel





# FACILITIES



## RAIL

### TECNOVE - METRO CHILE

- ✓ Spray booth with side suction manifolds







# FACILITIES



## INDUSTRY

### **FONTANELLAS I MARTI (Barcelona)**

- ✓ Automatic plant for the treatment and painting of leather.





# FACILITIES



## INDUSTRY

### UNIBIKE (Portugal)

- ✓ Automatic plant with overhead conveyor, for the treatment and painting (liquid and powder painting) of bicycles.





# FACILITIES



## INDUSTRY

### LUXIN TEC

- ✓ Side suction spray booth.
- ✓ Drying oven with endothermic panels
- ✓ Painting installation for the painting of luminaires. Painting booth. Curing oven







# FACILITIES



## INDUSTRY

### KAUFMAN

- ✓ Paint booth.
- ✓ Curing oven for large pieces.





# FACILITIES

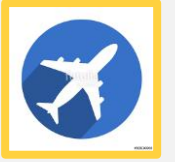

## AERONAUTICA

### STELIA (Portugal)

- ✓ Installation for painting aeronautical parts.







# FACILITIES

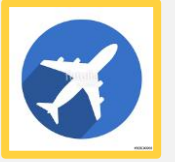

## AERONAUTICA

### BABCOK (Extremadura)

- ✓ Hangar type cabin, for aircraft painting.





# FACILITIES

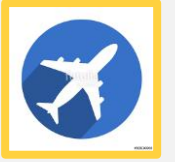

## AERONAUTICA



### INMAPA AERONAUTICA (Palencia)

- ✓ Cabin + In-line oven,  
for the painting of  
aeronautical  
components.





Parque Empresarial Campollano Calle C, N° 50,  
02007 Albacete - Spain  
Tel: (+34) 967 520 002  
[info@martechcorporation.com](mailto:info@martechcorporation.com)  
[www.martechcorporation.com](http://www.martechcorporation.com)